



## DESCRIPTION

The Standard enclosure (See Exhibit 1) is made of 18 gauge steel with a baked on enamel finish (red or black). It is designed so that it can be surface or flush mounted. Numerous conduit knockouts are provided on all four sides of the enclosure to facilitate easy wiring access into the enclosure. The knockouts allow connection of either 1/2" or 3/4" conduit. The removable exterior door is hinged on the left side of the back-box and is equipped with a key-lock to prevent unauthorized access to system components.

Threaded press-studs are supplied in enclosure back-box for easy installation of the following system components (sold separately):

- A. CyberCat™ Controller (qty. 1)
- B. CyberCat™ AC Power Transformer (qty. 2)\*
- C. Bosch FPT-DACT-LC, P/N 10-2528
- D. Class A Peripheral Bus Card, P/N 10-2792\*
- E. Multi-Interface Module (MIM), P/N 10-2583\*
- F. Ethernet Module, P/N 10-2627\*
- G. Two 18 AH batteries (maximum)

*\*Secondary power transformer, MIM, Ethernet module and Class A Peripheral Bus card share a common mounting location. Only one component can be installed at a time.*

See Exhibit 2 for component layout within the enclosure.

The enclosure can be ordered with an optional dead-front door panel that isolates the operator from the internal electronics and wiring; yet allows access to system display and control buttons. The dead-front door is hinged, which allows it to be easily opened to reveal the system components for maintenance purposes. The following control and display cards (sold separately) can be mounted to the 3 card dead-front door panel:

- Smoke Control Switch Card, P/N 10-2658
- Input/Output Switch Card, P/N 10-2659
- Annunciator Card, P/N 10-2660
- Audio Control Card, P/N 10-2661
- Fire-Phone Card, P/N 10-2728
- Supplemental Fire-Phone Card, P/N 10-2730
- City Tie Disconnect Switch, P/N 10-2721

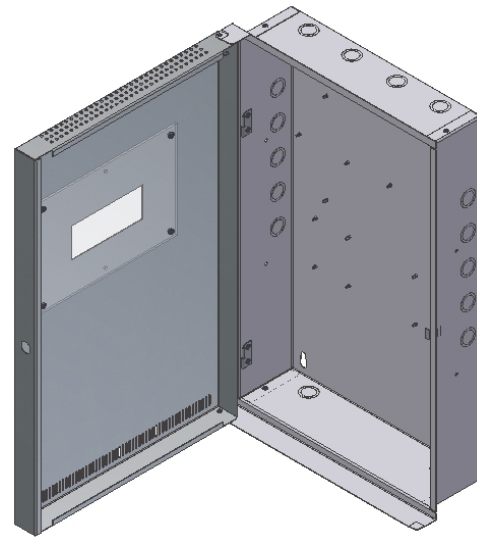

**Exhibit 1: Standard Enclosure**  
(shown without a dead-front)

## ENCLOSURE OPTIONS

### Standard Enclosure w/o Dead-front

Part Numbers: 10-2527-c-L (CyberCat 254)  
10-2483-c-L (CyberCat 1016)  
Weight: 16 lbs. (7.3 kg)  
(door and back box)

### Standard Enclosure w/ Solid Dead-front

Part Numbers: 10-2527-c-L-0 (CyberCat 254)  
10-2483-c-L-0 (CyberCat 1016)  
Weight: 21 lbs. (9.5 kg)  
(door, dead-front, and back box)

### Standard Enclosure w/ 3 Card Dead-front

Part Numbers: 10-2527-c-L-3 (CyberCat 254)  
10-2483-c-L-3 (CyberCat 1016)  
Weight: 19 lbs. (8.6 kg)  
(door, dead-front, and back box)

## SUPPLIED MOUNTING HARDWARE

The following mounting hardware is supplied with the enclosure for future installation of the electronic components. *Store inside the enclosure after installation.*

02-12033	Standoff Kit
02-2715	M/F Standoff, .625" (qty. 5)
02-12014	Hardware Kit
02-12025	Key (qty. 1)
4153-142	Lock Washer, #6 (qty. 2)
02-1361	6-32 Hex Nut (qty. 2)
02-4992	Ground Wire (qty. 1)
02-4035	Nut and star washer kit
	(contains 20 nuts and washers)

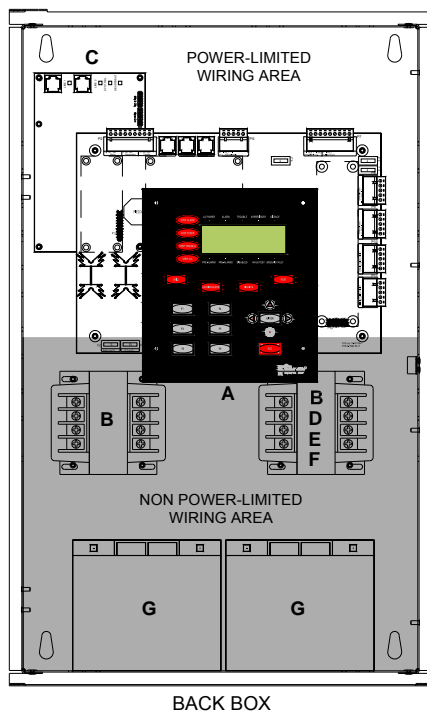

**Exhibit 2: Enclosure Layout**

## MOUNTING LOCATION

The following guidelines shall be adhered to when selecting the enclosure mounting location:

1. Mount the enclosure on a surface that is vibration free, clean and dry.
2. Mount the enclosure in an area that is free from sources of electromagnetic interference and radio frequency interference; as these are types of problems that could adversely affect the successful operation and useful life of the electronic equipment housed in the enclosure.
3. Mount the enclosure in an environment with a nominal room temperature of 15°-27°C / 60° - 80°F, with a relative humidity of 85 percent.
4. Allow sufficient clearance around the enclosure to allow the door to swing freely.
5. Mount the enclosure at a height that allows easy access to system electronic components for maintenance and service.

## INSTALLATION

1. Determine the quantity and size of conduit to be attached to the enclosure and remove appropriate knockouts. Do not use conduit knockouts located in the bottom of the enclosure if installing batteries.

**Note:** Fire Alarm System wiring is classified as either power-limited or nonpower-limited per NEC Article 760. All power-limited wiring must be separated from all nonpower-limited wiring by a minimum distance of 1/4" (6 mm). Refer to documentation provided with each electrical component for designation of power-limited versus nonpower-limited circuits.

2. Mount the enclosure at the selected location. See Exhibit 3 for enclosure dimensions. Both the outer and inner (dead-front) doors can be removed to make installation of the back box easier. Remove the outer door by unscrewing the two hinge screws. Remove the inner door by simply lifting it off its hinge pins.

### Surface Mounting

Utilize the four tear-drop openings in the back of the back box to secure it to the mounting surface with suitable anchors.

### Flush Mounting

Cut an opening in the wall to fit the back box dimensions and secure the box in place utilizing the through holes provided on the sides of the back box.

### CAUTION

The enclosure is NOT fire rated. Do not mount on or in a fire rated wall unless wall is properly framed to maintain specific fire rating.

3. Reinstall the inner and outer doors and connect the door grounding wires using the hardware provided, as shown in Exhibit 4. Adjust routing of grounding wires as necessary to allow full movement of both the inner and outer doors.
4. After enclosure is cleaned and free from all construction dust; install electronic components into the enclosure using the installation instruction supplied with each enclosure.

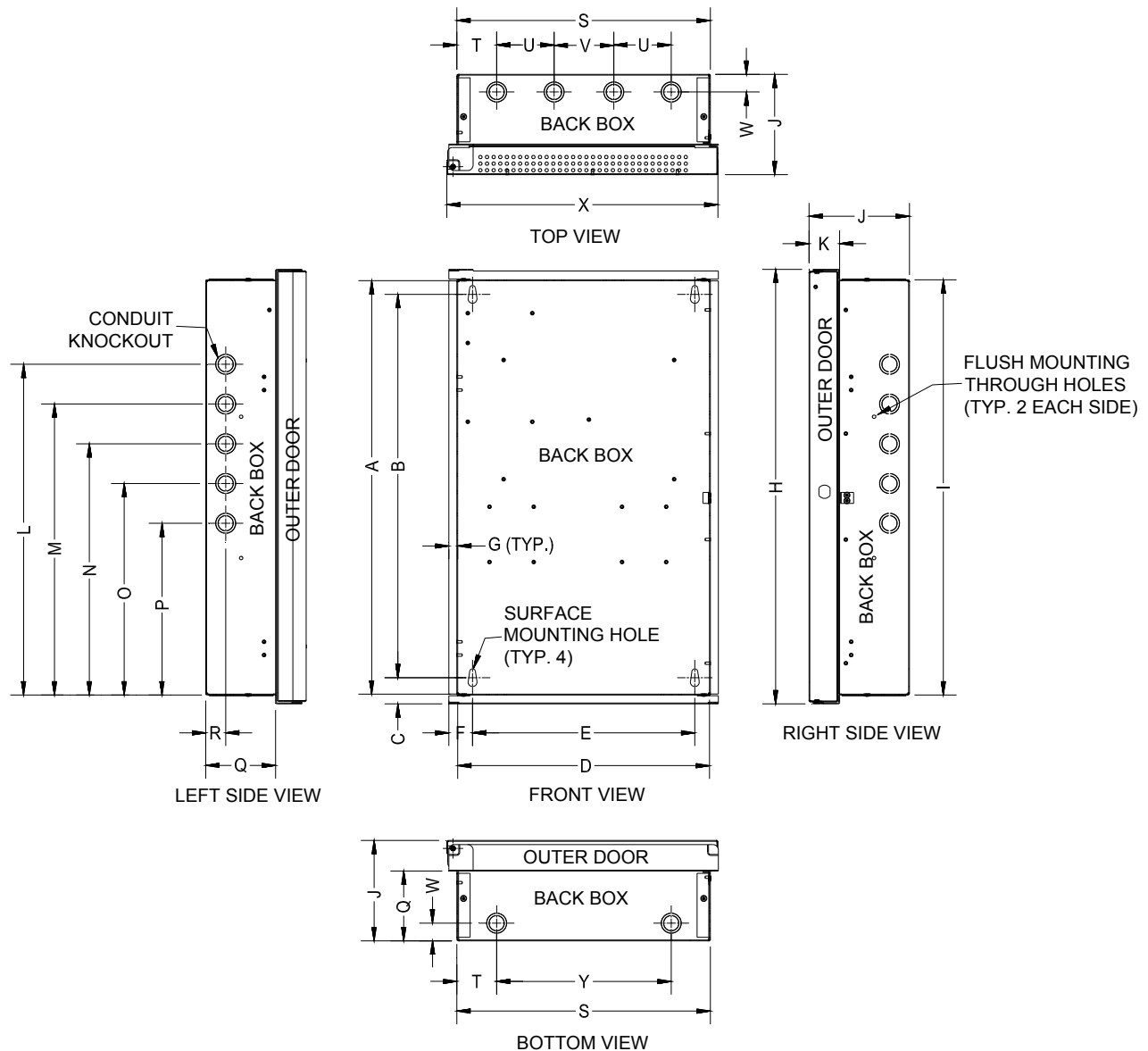

**Exhibit 3: Enclosure Dimensions**

Enclosure Dimensions			
A	23.41 in [59.46 cm]	N	14.22 in [36.12 cm]
B	21.70 in [55.12 cm]	O	11.97 in [30.40 cm]
C	1.48 in [3.76 cm]	P	9.72 in [24.69 cm]
D	14.25 in [36.21 cm]	Q	3.95 in [10.03 cm]
E	12.58 in [31.95 cm]	R	1.13 in [2.86 cm]
F	1.34 in [3.40 cm]	S	14.35 in [36.44 cm]
G	0.50 in [1.27 cm]	T	2.25 in [5.72 cm]
H	24.60 in [62.48 cm]	U	3.25 in [8.26 cm]
I	23.50 in [59.69 cm]	V	3.38 in [8.59 cm]
J	5.68 in [14.43 cm]	W	1.00 in [2.54 cm]
K	1.73 in [4.40 cm]	X	15.34 in [38.97 cm]
L	18.72 in [47.55 cm]	Y	9.88 in [25.10 cm]
M	16.47 in [41.83 cm]	Z	-

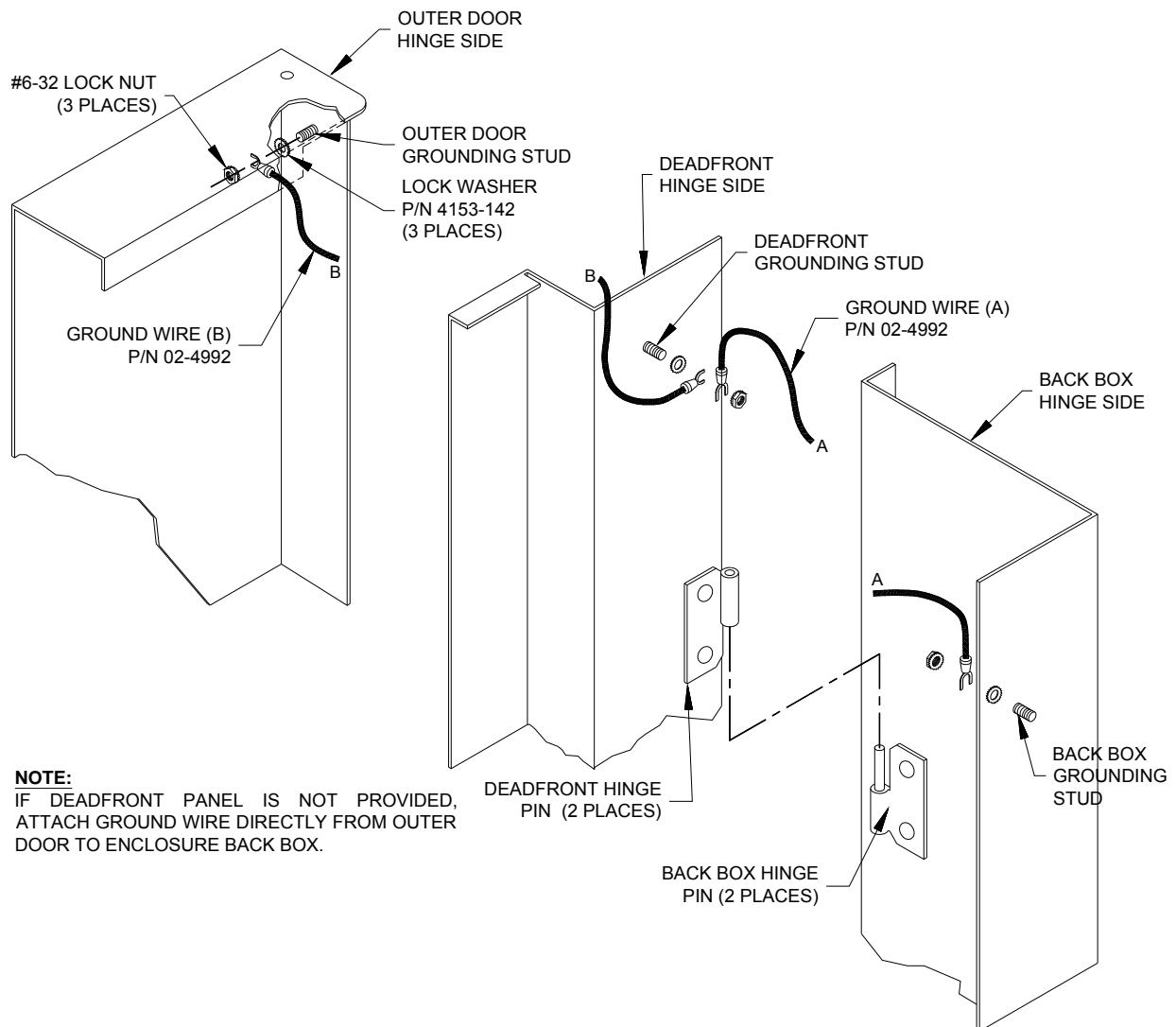

**Exhibit 4: Ground Wire Installation**