

HRD RELOAD PARTS

DESCRIPTION

After activation the Fike High Rate Discharge (HRD) container can be refurbished using the Fike reload parts as detailed below.

Refurbishing the container must only be performed by a Fike service technician or trained site personnel, using original Fike parts only!

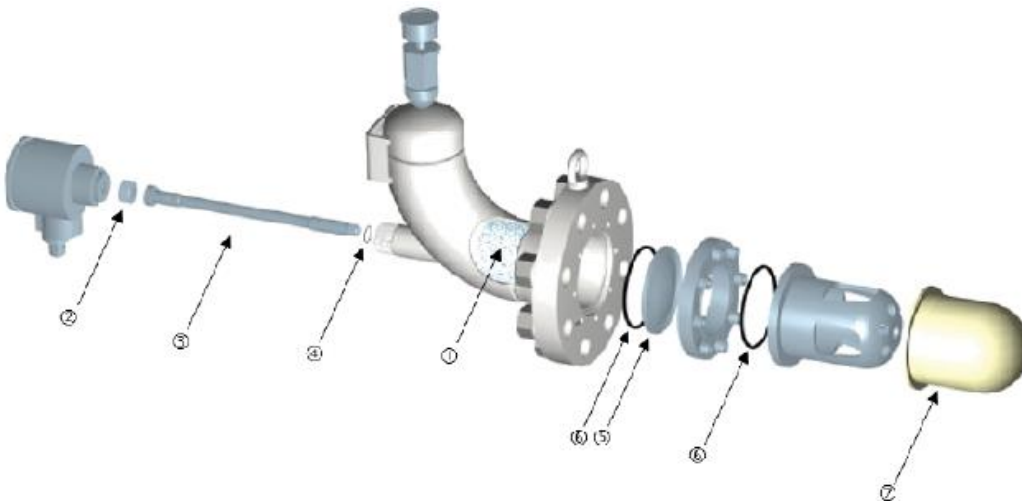

The Reload Kit HRD consists of the following parts (refer to the drawing)

- | | | | | |
|----------------------------|---|---|-----------------------------------|----------------------------|
| ① Suppressant powder | } | → | shipped in a white plastic bucket | |
| ② Jam nut | | } | → | shipped in a cardboard box |
| ③ Initiator boss | | | | |
| ④ O-ring 21 x 2.5 | | | | |
| ⑤ Scored rupture disc | | | | |
| ⑥ O-ring 110 x 3.5 | | | | |
| ⑦ Nozzle cover (see notes) | | | | |



The initiator in safety enclosure: The Valve Actuator Assembly (GCA) in safety enclosure which will be shipped in a separate wooden box according to ADR and IATA regulations for 1.4S products - unless not required by local or national authorities.



NOTES

Depending on the type of nozzle the 'Nozzle cover' will be of type 7, 8 or 9.

For containers with a telescopic nozzle the reload kit will also contain a nozzle damper quad ring that supports the telescopic nozzle upon activation.

For containers with a 6" telescopic nozzle the reload kit will also contain 4 small Teflon screws for additional support of the heavy 6" nozzle.

