

SUPPRESSANT CONTAINERS

DESCRIPTION

Fike suppressant containers provide optimum performance in delivering chemical suppressant agent in suppression and isolation applications.

The patented high-rate-discharge (HRD) suppressant containers are specifically designed to reduce the time required to inject and disperse the agent, suppressing the explosion. HRD containers can be used in both suppression and chemical isolation applications. HRD containers are available in six sizes ranging from 2.5-liters to 50-liters.

The standard-rate-discharge (SRD) suppressant container is available in a 9-liter size and used specifically for chemical explosion isolation. Chemical isolation is often used in conjunction with explosion suppression and explosion venting applications to protect interconnected vessels.

HRD containers comply with ASME Boiler and Pressure Vessel Code and are available with Canadian Registration Numbers (CRN). The SRD container complies with DOT Regulations and is available to meet Transport Canada Regulations. HRD and SRD containers are available with a Low Pressure Switch that, when connected to the supervisory input contact of the controller, satisfies the NFPA requirement for continuous container pressure monitoring.

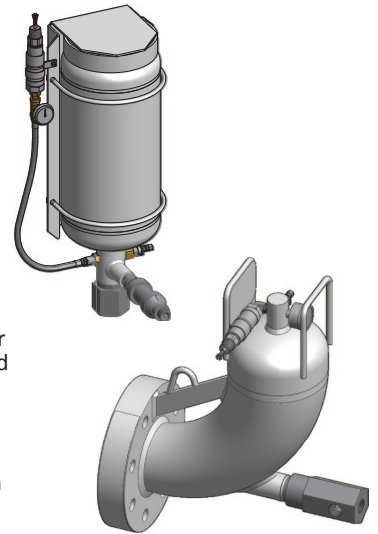

STANDARD FEATURES AND BENEFITS

Patented 90° elbow and zero restriction nozzle opening	Delivers suppressant agent faster reducing overall pressure and damage to vessel and protects a wider range of hazards
Gas cartridge actuator with 10 year service life	Reduces maintenance and cost of ownership. GCA's may be easily removed for maintenance without depressurization or removing container from vessel
Variety of suppressant agents	Protects against a wide range of hazards
Field refurbishable	Return to normal operating conditions faster, easier, and cheaper
Designed for optimal throw distance	Enables better, faster suppression reducing pressures and protects vessel from damage
Optional Features	Mechanical Lockout, Ball Valve Lockout, Low Pressure Switch, GCA Lockout

SPECIFICATIONS

System Approvals:	Factory Mutual, ATEX*
Ambient Temperature Range:	-30 to 140°F (-34 to 60°C)
Pressure Gauge:	Standard
Materials of Construction:	Pressure Vessel: High grade carbon steel with white baked urethane enamel Initiator Housing: SST Pressure Gauge: SST
Paint Specification:	All exposed surfaces: White baked urethane enamel
Low Pressure Switch:	Optional: Supervisory input contact (can be wired NO or NC) Set Pressure: SRD=400 psig, HRD=700 psig Electrical Connection: 1/2" NPT Male Pressure Connection: Inlet 1/4" NPT Female

* Consult factory.

SUPPRESSANT AGENTS

Fike offers a variety of environmentally safe suppressant agents to meet your specific application. Agents include Sodium Bicarbonate (available in standard or food grades), Monoammonium Phosphate, and a water-based agent.

DISPERSION NOZZLES

Fike patented dispersion nozzles are designed to provide the widest possible dispersion of the suppressant agent. Refer to the Fike Datasheets for specific information on dispersion nozzles.

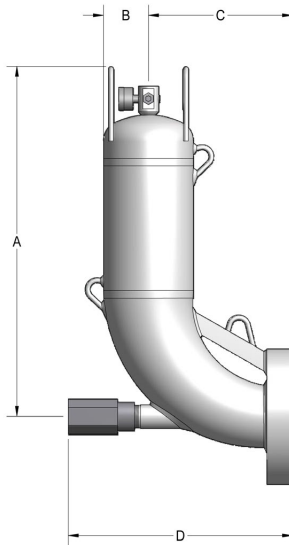

Suppressant Container

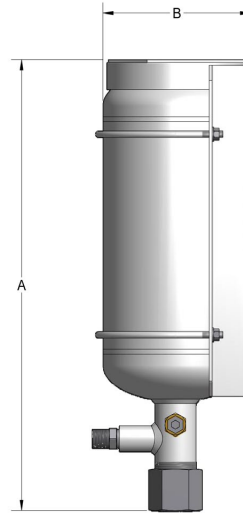

Chemical Isolation Container

Note: See the table below for overall dimensions of specific containers. These illustrations are not to scale. All specifications are subject to change without notice.

Type	Size (liters)	Dimensions (IN)				Mounting Flange	Empty Weight (pounds)
		A	B	C	D		
HRD	2.5	12 1/16	2 15/16	7 5/8	16 1/4	4" ANSI 300	67
HRD	5	16 1/16	3 5/16	10 5/8	16 1/2	4" ANSI 300	95
HRD	10	25 13/16	3 5/16	10 5/8	16 1/2	4" ANSI 300	118
HRD	20	30 9/16	5 3/8	12 11/16	16 1/2	4" ANSI 300	206
HRD	30	38 13/16	5 3/8	12 11/16	16 1/2	4" ANSI 300	220
HRD	50	49 1/16	5 3/8	15 1/8	20 9/16	6" ANSI 300	310
SRD	9	21 3/4	7 1/2	-	-	-	30