

OPTICAL DETECTOR MOUNTING CONFIGURATIONS

MOUNTING OPTIONS

The IREx Optical Detector can be mounted to a process in one of two ways: Rigid Mount and NA Connect® Flush Mount.

RIGID MOUNT KIT

The Rigid Mount Kit and ferrule is a robust configuration. The Rigid Mount Kit requires a 2" tri-clamp ferrule process connection.

Rigid Mount Kits w/ Tri-Clamp Adapter	
Part Number	Description
E61-063-1	Rigid Mount Kit for EP Detector w/ 304 SST 2" Tri-Clamp, PTFE Gasket, 316L SST Detector Flange
E61-063-2	Rigid Mount Kit for EP Detector w/ 304 SST 2" Tri-Clamp Viton Gasket, 316L SST Detector Flange
E61-063-3	Rigid Mount Kit for EP Detector w/ 304 SST 2" Tri-Clamp, PTFE Gasket, 316L SST Detector Flange with Air Purge
E61-063-4	Rigid Mount Kit for EP Detector w/ 304 SST 2" Tri-Clamp, Viton Gasket, 316L SST Detector Flange with Air Purge
E61-063-5	Rigid Mount Kit for EP Detector w/ 304 SST 2" Tri-Clamp PTFE Gasket, HC276 Detector Flange

PROCESS CONNECTION

Part Number	Description
02-8598	Short Weld Ferrule 2" Tri-Clamp 316L SST x 1 3/4" (44 mm) LG

NA® CONNECT FLUSH MOUNT KIT

The NA Connect Mount Kit allows for flush mounting to a pipe or duct, although it is not recommended for harsh environments.

NA Connect Mounting Kits	
Part Number	Description
E61-065-1	NA Connect Mount Kit for EP Detector w/ 316L SST NA Connect, PTFE Gasket, 316L SST Detector Flange
E61-065-2	NA Connect Mount Kit for EP Detector w/ 316L SST NA Connect Viton Gasket, 316L SST Detector Flange
E61-065-3	NA Connect Mount Kit for EP Detector w/ 316L SST NA Connect PTFE Gasket, 316L SST Detector Flange with Air Purge
E61-065-4	NA Connect Mount Kit for EP Detector w/ 316L SST NA Connect Viton Gasket, 316L SST Detector Flange with Air Purge

Note: Fiber optic Light Guide cables are available as an accessory for special application.
For more information refer to Data Sheet X.1.47.01.



Rigid Mount Kit
Detector sold separately



Short Weld Ferrule

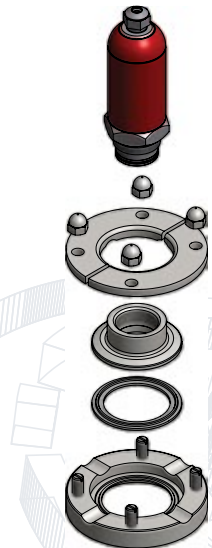

NA Connect Mount Kit
Detector sold separately

(This page is left blank intentionally)