

PROINERT®2 PNEUMATIC ACTUATOR ASSEMBLY

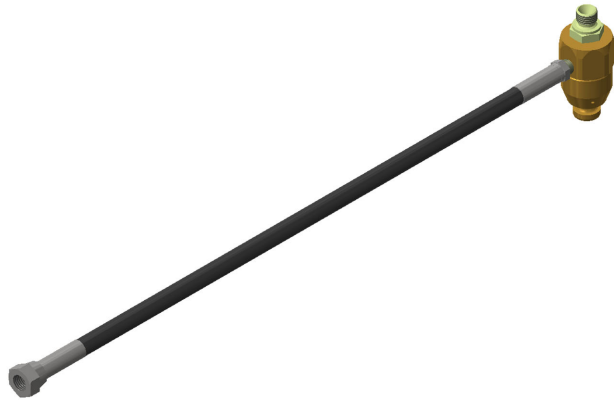

Description

The pneumatic actuator assembly is mounted to the valve actuator port on all ProInert 'Secondary' cylinders. The assembly is used to pneumatically activate the ProInert cylinder valve it is connected to using the discharge pressure from the 'Primary' cylinder or 'Primary' nitrogen actuator. Once activated, the actuator will latch in the fired position and must be manually reset using a Fike reset tool before being re-installed onto the cylinder valve.

The assembly is equipped with a flexible pilot hose to facilitate connection to the next actuator (pneumatic or relay) on a multiple cylinder system. This pilot line connection allows the discharge pressure from the 'Primary' cylinder to pass through each actuator to the next to facilitate pneumatic activation of up to 60 cylinder valves.

Approvals

Underwriters Laboratories (UL)
 Underwriters Laboratories of Canada (ULC)
 Factory Mutual (FM)

For exact certification listings, please reference the respective agency web site.

Specifications

Actuator Material	Brass Body Stainless Steel Piston
Actuator Operating Pressure	73 psi (5 bar) minimum
Actuator Working Pressure	2320 psi (160 bar)
Hose Material	Steel Braid with Polyurethane Cover
Hose Pressure Rating	4400 psi (310 bar)
Hose Overall Length	19" (483 mm)
Hose Minimum Bend Radius	1.6" (40 mm)
Hose End Connector	G1/4(F) Swivel

Ordering Information

The pneumatic actuator assembly can be ordered separately using the part number listed below or it can be ordered as part of the discharge valve completer kit.

Part Number	Description
IG71-104	Pneumatic Actuator Assembly

This document is only intended to be a guideline and is not applicable to all situations. Information is subject to Fike's full disclaimer at <http://www.fike.com/disclaimer>.