

CONVENTIONAL PRE-BULGED RUPTURE DISC (CPD)

DESCRIPTION

The Fike Conventional Pre-bulged Disc (CPD) is a solid metal/single element, pre-bulged (pre-formed), rupture disc which serves as a differential pressure relief device. The CPD can be used as a primary or secondary pressure relief device, or used in combination with other pressure relief devices. Designed for installation in flanges which utilize the standard 30° angular seating arrangement. The CPD disc is forward-acting or tension loaded.



CPD discs shown with Union Type holder

SPECIFICATIONS

Materials of Construction	Inconel®, Aluminum, Nickel
Maximum Operating Ratio	70%
Standard Burst Pressure Range	75 - 30,000 PSIG
Burst Tolerance	±5%
Sizes	1/4", 1", 1-1/2", 2"
Maximum Temperature	Inconel 600 - 1100°F (593°C) Nickel - 800°F (427°C) Aluminum - 250°F (121°C)
Holder	Union Type and Hammer Union available in carbon steel (See data sheet R.1.09.01 for more details)

Note: other sizes, pressures, tolerances, and materials available upon request

FEATURES AND BENEFITS

- Custom builds and sizing
- Certified Burst Pressure
- Simple operation with no moving parts
- Rapid response delivery of popular sizes, burst pressures, and materials
- Sub-millisecond response time for critical pressure relief
- Reliable even under severe operating conditions

TYPICAL OILFIELD APPLICATIONS

- Separators
- Storage Tanks
- Dehydration Units
- Water Knockouts
- Heater Treaters
- Filtration Systems
- Well Head Protection
- High Pressure Test Units
- Production Testing Units
- Gas Production Units

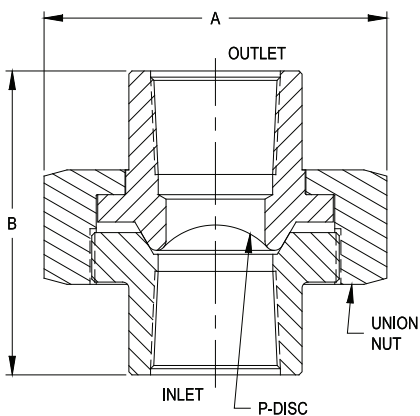

Union Holder

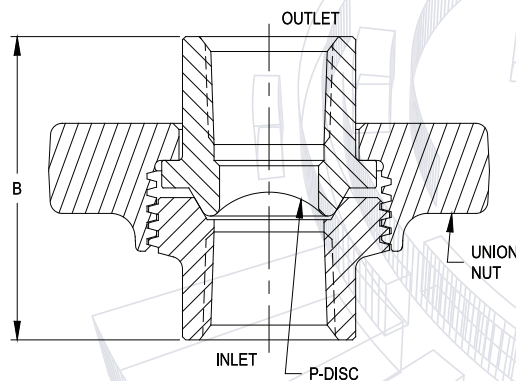

Hammer Union Holder

Form No. O.1.02.01-5

CONVENTIONAL PRE-BULGED RUPTURE DISCS				
CPD P/N	Size (IN)	Pressure Rating PSIG @ 72°F (22°C)	Rupture Tolerance	Material
*1-025-12500-1	1/4	12500	±5%	INC
*1-025-17500-1	1/4	17500	±5%	INC
*1-025-22500-1	1/4	22500	±5%	INC
*1-025-25000-1	1/4	25000	±5%	INC
*1-100-125-4	1	125	±5%	NI
*1-100-250-1	1	250	±5%	INC
*1-100-375-1	1	375	±5%	INC
*1-100-500-1	1	500	±5%	INC
*1-100-600-1	1	600	±5%	INC
*1-100-1000-1	1	1000	±5%	INC
*1-100-1200-1	1	1200	±5%	INC
*1-100-1440-1	1	1440	±5%	INC
*1-100-1500-1	1	1500	±5%	INC
*1-100-1600-1	1	1600	±5%	INC
*1-100-2000-1	1	1600	±5%	INC
*1-100-3000-1	1	1600	±5%	INC
*1-150-125-4	1-1/2	125	±5%	NI
*1-150-150-1	1-1/2	150	±5%	INC
*1-150-200-1	1-1/2	200	±5%	INC
*1-150-250-1	1-1/2	250	±5%	INC
*1-150-333-1	1-1/2	333	±5%	INC
*1-150-500-1	1-1/2	500	±5%	INC
*1-150-1000-1	1-1/2	1000	±5%	INC
*1-150-1200-1	1-1/2	1200	±5%	INC
*1-150-1440-1	1-1/2	1440	±5%	INC
*1-150-1111-1	1-1/2	1111	±5%	INC
*1-150-1500-1	1-1/2	1500	±5%	INC
*1-150-1600-1	1-1/2	1600	±5%	INC
*1-200-125-1	2	125	±5%	INC
*1-200-250-1	2	250	±5%	INC
*1-200-500-1	2	500	±5%	INC
1-200-1000-1	2	1000	±5%	INC
1-200-1440-1	2	1440	±5%	INC
1-200-1600-1	2	1600	±5%	INC
1-200-2000-1	2	2000	±5%	INC
Union Holder P/N	Size (IN)	Pressure Rating	Configuration	Material
*1 30BU-CS	1	3000	Threaded Base, Threaded hold-down (BU)	CS
*1 50 30BU-CS	1-1/2	3000		CS
2 7 BU-CS	2	750		CS
Hammer Union Holder P/N	Size (IN)	Pressure Rating	Configuration	Material
*1 60HU	1	6000	Threaded Base, Threaded hold- down	CS
*1.50 60HU	1-1/2	6000		CS
*2 20HU	2	2000		CS

* Indicates rapid response item

Union Type and Hammer Union				
Type	Pipe Size	Max. Rating PSIG at 100°F	Width Across Flats (IN) (A)	Approximate Height (IN) (B)
Union	1	3000	2-9/16	2-1/2"
	1-1/2	3000	3-7/16"	3"
	2	750	5"	3-7/16"
Hammer Union	1	6000	-	3-3/32"
	1-1/2	6000	-	3-9/32"
	2	2000	-	3-15/16"